



DEPARTMENT OF INSTRUMENTATION & CONTROL ENGINEERING

COEP TECHNOLOGICAL UNIVERSITY, PUNE, 411005
Wellesely Rd, Shivajinagar, Pune-411 005. Maharashtra, INDIA.
Telephone: +91-20-25507600 Fax: +91-20-25507299

No.COEP Tech /Instru/Furniture-Biomedical /2025/ 382

Date: 20 JAN 2025

ENQUIRY LETTER

Dear Sir,

Sealed quotations are invited for new furniture construction in Biomedical Laboratory, Instrumentation & Control Engg. Department from reputed manufactures suppliers.

Enquiry Number	COEPTech/Instru/ Furniture -Biomedical /2024-25/
Enquiry Date	27/01/2025
Work Description	Mentioned in Annexure A
Location	HOD Cabin, 1st Floor, Instrumentation & Control Engg. Department
Quotation Submission Date@ Time	05/02/2025 @ 5.00 p. m.
Quotation Opening Place	HOD Cabin 1st Floor, Dept. of Instrumentation and Control, COEP Technological University, Pune

Terms & Conditions:-

1. Fax and Email quotation are not acceptable.
2. The taxes, GST, insurance, freight, packing and forwarding charges if any are quoted in Indian Rupees separately & clearly.
3. The rates shall be valid for 10 days.
4. Validity: Quotation Validity at least 10 days from the due date.
5. Quotations shall be sent in sealed envelopes clearly marked. Quotation for new furniture construction (Annexure A) in Biomedical Laboratory, Instrumentation and Control Engg. with Enquiry Number, Enquiry date and Enquiry due date addressed to The Head, Instrumentation & Control, COEP Technological University Pune-411 005.
6. 100% payment will be paid after satisfactory completion of work.
7. Delivery/Working Period and Terms Conditions should be mentioned clearly.
8. Delayed supplies: The penalty conditions are applicable for the late delivery/working as per norms.
9. Optional items should be quoted in separate sheet otherwise your quote will be rejected.
10. The Vice Chancellor, COEP Technological University Pune-411 005 reserves rights to reject any one or all the quotation(s) without assigning any reasons therefore.

28.1.25

Registrar

COEP Technological University, Pune

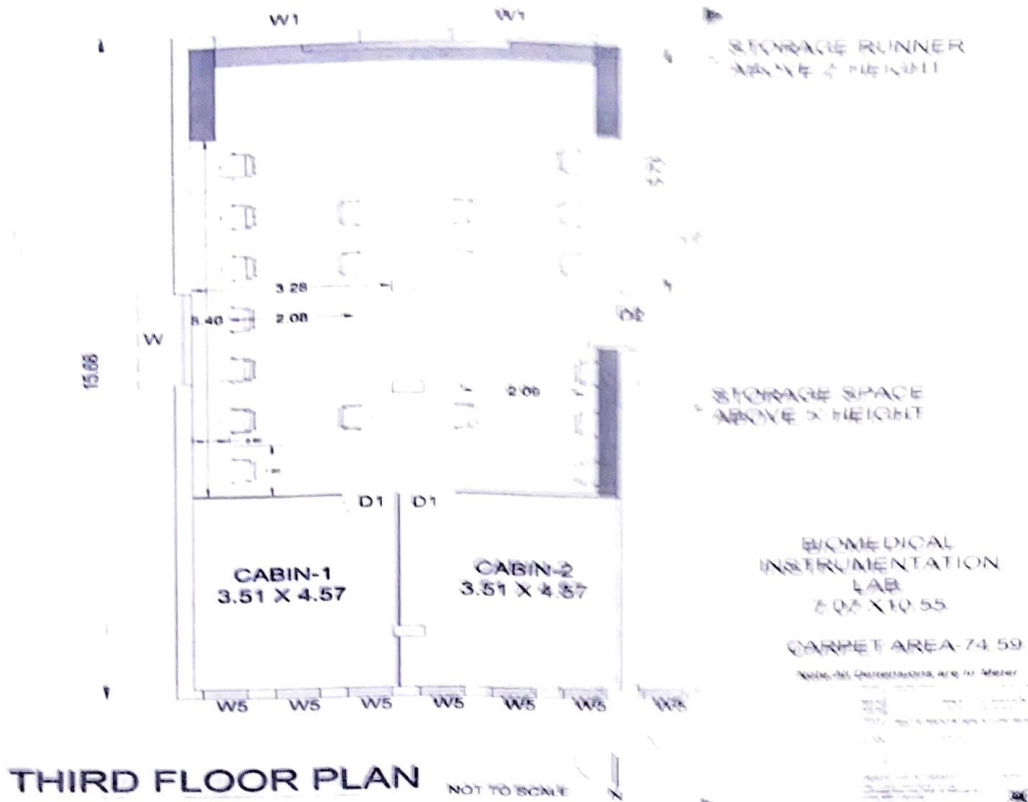

Revised Layout

Annexure A

Dimensions are not as per scale. It is only for illustration purpose.

Sr.	Material Specification
1	Mat – PVC flooring of width 25ft X length 45 ft (approximately)
2	Hanging Cupboard height 2ft X length 10ft X depth 2ft Laminate finish – Marino/ Green malce / Bingo or equivalent Ply 18 mm BWR or equivalent
3	Storage Cupboard width 5ft X height 8 ft X depth 2ft (Qty. 2 Nos.) Laminate finish - Marino/ Green malce / Bingo or equivalent Ply 18 mm BWR or equivalent
4	Runner height 3ft X length 20 ft X width 2ft
5	Lab. Center table Computer table - Left side length 10 ft X height 4 ft Computer table - Right side length 10 ft X height 4 ft With 4 drawer & 4 keyboard provision
6	Computer table – North Side , depth 2.5 ft X length 40 ft, (approximately 6 Computer table with provisions for keyboard & drawer, table top for all computer length 40ft X height 2ft. X depth 1 ft. Computer table – South Side , depth 2.5 ft X length 15 ft, (approximately 3 Computer table), depth 2.5 ft X length 10 ft, (approximately 2 Computer table) with provisions for keyboard & drawer, table top for all computer length 15ft X height 2ft. X depth 1 ft
7	Pillar paneling (Qty. 2 Nos.) 20 sq. ft. each, Total 40 sq. ft.
8	Wall paneling 400 sq. ft. approximately